

过渡接头 ADAPTER

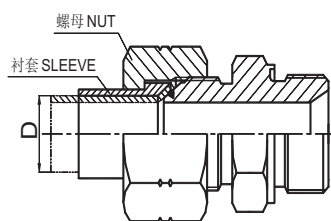
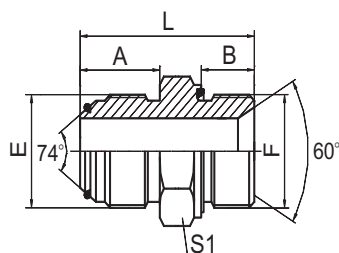

JIC 外螺纹 74° 外锥带
O 形圈 / 英管外螺纹胶垫密封
JIC MALE 74° CONE WITH
O-RING/BSP MALE CAPTIVE SEAL

1JB-OR/WD

代号 PART NO.	螺纹 THREAD		O 形圈 O-RING 胶垫 CAPTIVE		尺寸 DIMENSIONS				
	E	F	E 端	F 端	A	B	L	S1	
1JB-08-04OR/WD	3/4"X16	G1/4"X19	9.5X0.8	WD-B04	16.7	12	37	22	
1JB-08-06OR/WD	3/4"X16	G3/8"X19	9.5X0.8	WD-B06	16.7	12	37.5	22	
1JB-08OR/WD	3/4"X16	G1/2"X14	9.5X0.8	WD-B08	16.7	14	43.5	27	
1JB-08-12OW/WD	3/4"X16	G3/4"X14	9.5X0.8	WD-B12	16.7	16	45	32	
1JB-10-06OR/WD	7/8"X14	G3/8"X19	13X1	WD-B06	19.3	12	41.5	24	
1JB-10-08OR/WD	7/8"X14	G1/2"X14	13X1	WD-B08	19.3	14	46.5	27	
1JB-10-12OR/WD	7/8"X14	G3/4"X14	13X1	WD-B12	19.3	16	47.5	32	
1JB-12OR/WD	1.1/16"X12	G3/4"X14	17X1	WD-B12	21.9	16	50	32	
1JB-12-06OR/WD	1.1/16"X12	G3/8"X19	17X1	WD-B06	21.9	12	46	30	
1JB-12-08OR/WD	1.1/16"X12	G1/2"X14	17X1	WD-B08	21.9	14	48.5	30	
1JB-12-16OR/WD	1.1/16"X12	G1"X11	17X1	WD-B16	21.9	18	56	41	
1JB-12-20OR/WD	1.1/16"X12	G1.1/4"X11	17X1	WD-B20	21.9	20	60	50	
1JB-16OR/WD	1.5/16"X12	G1"X11	22X1.5	WD-B16	23.1	18	57	41	
1JB-16-12OR/WD	1.5/16"X12	G3/4"X14	22X1.5	WD-B12	23.1	16	53	36	
1JB-16-20OR/WD	1.5/16"X12	G1.1/4"X11	22X1.5	WD-B20	23.1	20	61	50	
1JB-20OR/WD	1.5/8"X12	G1.1/4"X11	28X1.5	WD-B20	24.3	20	62	50	
1JB-20-16OR/WD	1.5/8"X12	G1"X11	28X1.5	WD-B16	24.3	18	58	46	
1JB-20-24OR/WD	1.5/8"X12	G1.1/2"X11	28X1.5	WD-B24	24.3	22	64	55	
1JB-24OR/WD	1.7/8"X12	G1.1/2"X11	35X1.5	WD-B24	27.5	22	67.5	55	
1JB-24-20OR/WD	1.7/8"X12	G1.1/4"X11	35X1.5	WD-B20	27.5	20	65.5	50	
1JB-32OR/WD	2.1/2"X12	G2"X11	48X2	WD-B32	34	20	73	75	

注：螺母及衬套需另行订货。管子直径 D 为公制时，配用螺母及衬套分别选用 NB200、NB500。管子直径为英制时，配用螺母及衬套分别选用 NB200、NB300。 Nut and sleeve should be ordered separately. The nut NB200 and sleeve NB500 is suitable for metric tube, the nut NB200 and sleeve NB300 is suitable for inch tube.